

Location Map  
Not to Scale



OPEN SPACE CALCULATIONS:  
REQUIRED: 14 UNITS X 300 SF/UNIT=4,200 SF  
PROVIDED: 194,547 SF(TOTAL LOT AREA) - 32,171 SF(AREA USED FOR INFRASTRUCTURE)  
= 162,376 SF (OPEN SPACE PROVIDED)

**LEGEND:**

	PROPERTY LINE
	BUILDING SETBACK
	EXISTING EDGE OF PAVEMENT
	PROPOSED EDGE OF PAVEMENT
	EXISTING POWER POLE
	EXISTING OVERHEAD ELECTRIC
	EXISTING WATER VALVE
	EXISTING FIRE HYDRANT
	EXISTING WATER LINE
	EXISTING SEWER VALVE
	EXISTING SEWER MANHOLE
	EXISTING GRAVITY SEWER

- NOTES:**
1. CONTOUR INFORMATION PRODUCED FROM AVAILABLE LIDAR DATA. TERRAIN MODEL.
  2. EXISTING SITE CONDITIONS BASED ON AERIAL PHOTOGRAPHY AND OR FIELD INVESTIGATION.
  3. PROPERTY BOUNDARIES WERE NOT SURVEYED BY TARE, INC. PROPERTY LINE INFORMATION OBTAINED FROM TAX RECORDS AND OR SUPPLIED BY OPERATORS OR OWNERS.

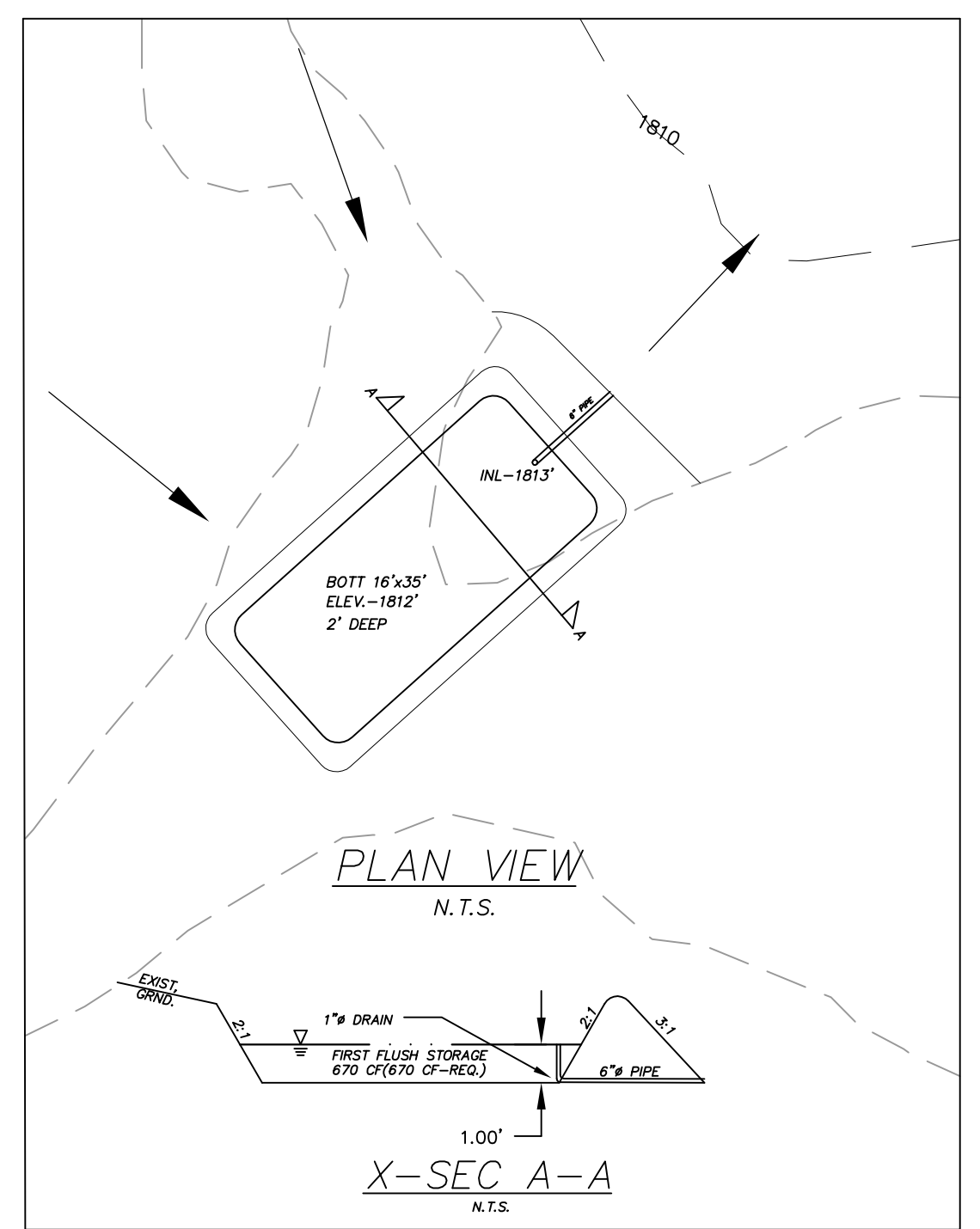

DETAIL STORM WATER MANAGEMENT STRUCTURE

**TARE, INC.**  
Terre-Aqua Resource Engineering, Inc.  
Crossville, Tennessee

SITE PLAN OF IRIS LANE DEVELOPMENT	
Located in the First Civil District of Cumberland County, Tennessee	
PRESENTED TO CROSSVILLE REGIONAL PLANNING COMMISSION	
DEVELOPER: Umiya Properties Management, LLC	SURVEYOR: .
ADDRESS: 957 West Ave, ST 104 CROSSVILLE, TN 38555	ADDRESS: .
TELEPHONE: 404-452-1289	TELEPHONE: .
ENGINEER: TARE, INC.	SCALE: 1" = 50'
ADDRESS: P.O. BOX 846 CROSSVILLE, TENNESSEE 38557	DATE: May, 2024
TELEPHONE: (931) 484-7543	TAX MAP REFERENCE: Tax Map 100K, B Parcel 10.05