

VICINITY MAP
CUMBERLAND COUNTY, TENNESSEE

FCPT HOLDINGS, LLC
D.B.: 1493, PG: 1330

HAYNES, GERALD W.
D.B.: 356, PG: 556

ELLIS, MICHAEL E.
D.B.: 421, PG: 571

TURNER, MORRIS EUGENE
D.B.: 382, PG: 458

COMMON GROUND

DRIVEWAY

WATER
SEWER

VAUGHN ST.

0.73 AC±

LEGEND

- △ EX. 1/2" REBAR
- ⊙ EX. 3" IRON PIPE
- ◆ EX. METAL FENCE POST
- CALCULATED POINT
- PROPERTY LINE
- - - - - ADJOINING PROPERTY LINE
- ===== ROAD RIGHT OF WAY

LINE	BEARING	DISTANCE
L1	S 22°02'44" E	11.68'
L2	S 26°22'05" W	18.23'

SURVEYOR'S CERTIFICATION
I hereby certify that the information shown on this plat is correct to the best of my ability and belief, these measurements were made by a field survey under the authority of TCA 61-18-12; and my supervision. This is a category 1 survey, and the ratio and precision of the unadjusted closure is 1:10,000 as per the State of Tennessee standards of practice, Chapter 8020-3. This survey was made according to information of public record and/or observed ground evidence.

10-6-22
Date

O.D. PUGH, JR.
Tennessee Registered Professional Surveyor
107 Livingston Rd.
Crossville, TN 38555
(931) 484-7702

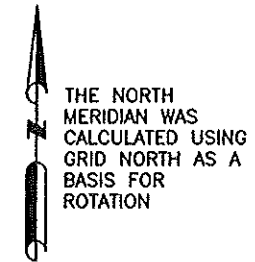
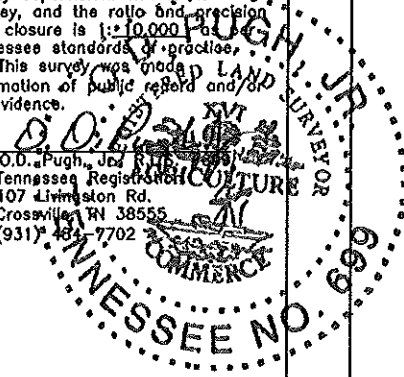

MID-STATE-SURVEYING
P.O. BOX 212 107 LIVINGSTON ROAD
CROSSVILLE, TENNESSEE 38557
PHONE: (931) 484-7702

SURVEYED FOR
KIRK FINLEY
OWNER: PATEL, VIPUL & PINKI
D.B.: 1550, PG: 1415

FIRST CIVIL DISTRICT OF CUMBERLAND COUNTY, TENNESSEE

TAX MAP: 100-G	DATE: OCTOBER 6, 2022	SHEET: 1 OF 1
PARCEL: 6.0	SCALE: 1" = 50'	DRAWING NO: 22144-2
GROUP: "B"		
DRAWN BY: ROBIN POWERS		