

Scale: 1" = 50'

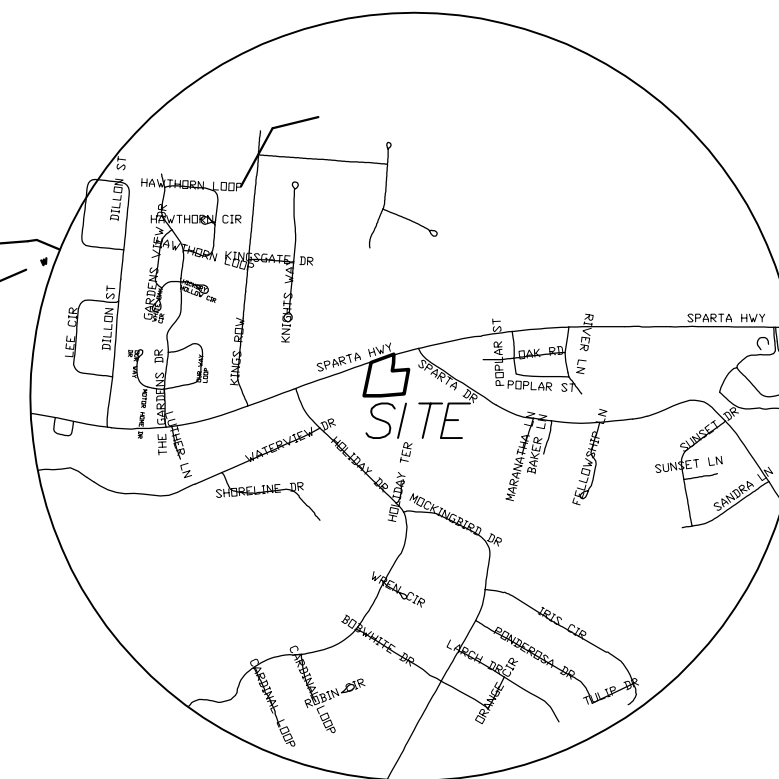

Location Map
Not to Scale

- LEGEND:**
- INDEX CONTOUR 10'
 - - - EXISTING CONTOUR 2'
 - PROPERTY LINE
 - BUILDING SETBACK
 - EXISTING EDGE OF PAVEMENT
 - PROPOSED EDGE OF PAVEMENT
 - EXISTING POWER POLE
 - OHE --- EXISTING OVERHEAD ELECTRIC
 - EXISTING FIRE HYDRANT
 - W --- EXISTING WATER LINE
 - S --- EXISTING SEWER MANHOLE
 - EXISTING GRAVITY SEWER
 - W --- PROPOSED WATER LINE
 - S --- PROPOSED HYDRANT
 - S --- PROPOSED SEWER MANHOLE OR CLEANOUT
 - PROPOSED GRAVITY SEWER LINE
 - STORMWATER MANAGEMENT AREAS
 - DRAINWAY
 - WATERSHED PEAK
 - PROPOSED CULVERT
 - LOT CORNER

NOTES:

1. CONTOUR INFORMATION PRODUCED FROM AVAILABLE LIDAR DATA.
2. EXISTING SITE CONDITIONS BASED ON AERIAL PHOTOGRAMITRY AND OR FIELD INVESTIGATION.
3. PROPERTY BOUNDARIES WERE SURVEYED.
4. ALL UNITS TO BE ON PRIVATE WATER AND SEWER LINES.

CONNECT PROPOSED
PRIVATE GRAVITY SEWER
TO EXISTING SEWER
MANHOLE ON PROPERTY

OPEN SPACE CALCULATIONS:
REQUIRED: 31 SINGLE FAMILY UNITS X 300 SF/UNIT=8,400 SF
PROVIDED: 213,075 SF(TOTAL LOT AREA) -125,603 SF(AREA USED FOR INFRASTRUCTURE)
= 87,472 SF (OPEN SPACE PROVIDED)

TARE, INC

Terre-Aqua Resource Engineering, Inc.
Crossville, Tennessee

SITE PLAN
OF
WALTON ESTATES
Located in the First Civil District of Cumberland County, Tennessee
PRESENTED TO
CROSSVILLE REGIONAL PLANNING COMMISSION

DEVELOPER: Spence Walton
ADDRESS: 2231 US-40
CROSSVILLE, TN 38555
TELEPHONE: 931-510-5940

SURVEYOR: G-1 and Associates
ADDRESS: 3824 MT Helen Road
ALLARDT, TN 38504
TELEPHONE: 931-879-6393

ENGINEER: TARE, INC.
ADDRESS: P.O. BOX 846
CROSSVILLE, TENNESSEE 38557
TELEPHONE: (931) 484-7543

SCALE: 1" = 50' DATE: April, 2025
TAX MAP REFERENCE: Tax Map 99L, Group C
ParcelS 008.00