

This Instrument prepared by:
State of Tennessee
Department of Transportation
Region 2
7512 Volkswagen Drive
Chattanooga, TN 37416.
(Local Government)

Project No. F-028-1(16)
299-A
Tract(s): Multiple
Cumberland County
Request No. 6893

LICENSE AGREEMENT

THIS AGREEMENT is made and entered into as of this the _____ day of _____, 2022, by and between THE STATE OF TENNESSEE, acting by and through its Commissioner of Transportation, (hereinafter referred to as “State”) and the **CITY OF CROSSVILLE, TENNESSEE** (hereinafter referred to as “Licensee”).

WHEREAS, Licensee desires to use a portion of the Licensed Premises to replace and, subsequently, maintain sidewalks to make them ADA compliant along Main Street (S.R. 28) between mile marker 13.710 and mile marker 14.083 in the city of Crossville in Cumberland County, Tennessee, being more specifically described in Exhibit A attached to and made a part of this License; and

WHEREAS, the State is willing to permit said use of the Licensed Premises subject to certain conditions.

NOW, THEREFORE, in consideration of the execution of this License Agreement, it is mutually agreed between the parties hereto as follows:

1. **LICENSE** – Licensee is hereby granted permission to replace and, subsequently, maintain sidewalks to make them ADA compliant along Main Street (S.R. 28) between mile marker 13.710 and mile marker 14.083 in the City of Crossville in Cumberland County, Tennessee (hereinafter referred to as the “Improvements”).
2. **USE OF LICENSED PREMISES** - Licensee shall be permitted to use the Licensed Premises **for a public use purpose, subject to cancellation for failure to continue public use** for the operation of the Improvements. Licensee shall not be permitted to use the Licensed Premises for any other purpose except by prior written permission of the State. Licensee’s use of the Licensed Premises is subject to any easements of record and to the right of any utility owner to operate and maintain any existing utility facilities within the Licensed Premises.
3. **FEE** – Licensee shall pay \$0 per year to the State for the use of the Licensed Premises.
4. **TERM** – The License is a 25 year, renewable license which shall begin on _____, _____ 2022 and shall end on _____, _____ 2047.
5. **ACCESS** – The State shall provide Licensee access to the Licensed Premises at all times for the uses authorized herein.
6. **MAINTENANCE** – The costs of any maintenance and operation of the Improvements shall be at the sole expense of Licensee;

7. **TRAFFIC CONTROL** - At no time will work authorized by this license agreement interfere with the normal flow of traffic on roadways adjoining the Licensed Premises. Licensee is responsible for providing traffic control for this work zone in accordance with the requirements of the current *Manual on Uniform Traffic Control Devices*. If proper traffic control is not in place, TDOT may order Licensee to stop work until proper traffic control is put in place.
8. **FIRE HAZARD** - The Property shall not be used for the manufacture or storage of flammable material or for any other purpose deemed by the STATE or the Federal Highway Administration to be a potential fire hazard or other hazard to the highway. The determination as to whether or not a use constitutes such a hazard shall be in the sole discretion of the STATE or the Federal highway Administration. The operation and maintenance of said property will be subject to regulation by the STATE to protect against fire or other hazard which could impair the use, safety or appearance of the highway. LICENSEE shall provide access, at all times, for firefighters and accompanying equipment.
9. **DAMAGE TO STATE PROPERTY** - Licensee shall be liable for any damage to state property resulting from Licensee's use of the Licensed Premises and/or installation and operation of the Improvements, including but not limited to, the roadway, shoulders, guardrail, drainage, landscaping, signs and controlled-access fences. All repair or replacement of such damage shall be made in accordance with the current TDOT Standard Specifications for Road and Bridge Construction, TDOT Standard Drawings and any other applicable design and/or construction standards or guidelines.
10. **LIABILITY** - Licensee shall assume all liability for claims arising out of conduct on the part of the Licensee for which it would be liable under the Tennessee Governmental Tort Liability Act, Tenn. Code Ann. § 29-20-101, et seq., up to the limits for which it can be held liable for such conduct under that act, arising from its use of the Licensed Premises. In addition, Licensee shall require that any contractor of Licensee that performs any work on the Licensed Premises, including any installation, maintenance, or operation of the Improvements, shall indemnify and hold harmless the State and all of its officers, agents and employees from all suits, actions or claims of any character arising from the contractor's acts or omissions in the prosecution of the work.
11. **INSURANCE** - The Licensee, its successors and assigns, agrees to maintain adequate public liability insurance, which may include self-insurance, and will provide satisfactory evidence of such insurance to the State. Further, the liability limits of this insurance must not be less than the exposure and limits of the Licensee's liability under the Tennessee Governmental Tort Liability Act, Tenn. Code Ann. § 29-20-101, et seq. The insurance policy shall include a provision for the insurance company to notify the State in writing of any cancellation or changes of the policy at least 30 days in advance of the cancellation or change. In addition, Licensee shall require that any contractor of Licensee that performs any work on the Licensed Premises, including any installation, maintenance, or operation of the Improvements, shall provide proof of adequate and appropriate general liability insurance providing liability coverage in an amount not less than \$1 million dollars per occurrence and \$300,000 per claimant, naming the State of Tennessee as an additional insured.
12. **PERMITS** - Licensee is responsible for obtaining and paying the costs of all permits, licenses or other approvals by any regulatory body having jurisdiction over the uses authorized herein. Prior to commencing the work authorized herein, Licensee shall notify Tennessee One Call regarding any excavation(s) and shall ensure that the provisions of TCA 65-31-101 et seq. are met.

13. **COMPLIANCE** – All work on the Licensed Premises shall be performed in compliance with current TDOT Landscape Design Guidelines and TDOT Standard Drawings in addition to applicable federal, state and local laws and regulations. Should Licensee fail or neglect to comply with any term or condition of this License Agreement or to comply with written notice and demand, this License shall be subject to termination. In the event of such termination, Licensee shall immediately remove any and all of its Improvements from the licensed Premises and surrender all rights and privileges under this License Agreement; otherwise, on written notification by the State, the Improvements will be removed and said Licensed Premises restored to its former condition in a timely manner at the expense of the Licensee.
14. **TITLE VI ASSURANCES** – The Licensee for itself, its successors in interest and assigns, as part of the consideration hereof does hereby covenant and agree that in the event facilities are constructed, maintained, or otherwise operated on the property described in this License Agreement for a purpose for which the State or a State program or activity is extended or for another purpose involving the provision of similar services or benefits, the Licensee shall maintain and operate such facilities and services in compliance with all other requirements imposed pursuant to Title 49, Code of Federal Regulations, Part 21, Nondiscrimination in Federally Assisted Programs of the Department of Transportation – Effectuation of Title VI of the Civil Rights Act of 1964, and as said regulations shall be amended.
15. **AMERICANS WITH DISABILITIES ACT ASSURANCES** – The Licensee for itself, its successors in interest and assigns, as part of the consideration hereof does hereby covenant and agree that in the event facilities are constructed, maintained, or otherwise operated on the property described in this License Agreement for a purpose for which the State or a State program or activity is extended or for another purpose involving the provision of similar services or benefits, the Licensee shall maintain and operate such facilities and services in compliance with all other requirements imposed pursuant to Title 28, Code of Federal Regulations, Parts 35 and 36, Nondiscrimination on the Basis of Disability in State and Local Government Services and Nondiscrimination on the Basis of Disability by Public Accommodations and in Commercial Facilities, and as said regulations shall be amended. The Licensee further agrees that if any pedestrian facilities are constructed, maintained, or operated on the property described in this License, the Licensee shall construct, maintain, and operate such facilities in compliance with the Architectural and Transportation Barriers Compliance Board’s “Accessibility Guidelines for Pedestrian Facilities in Public Rights-of-Way” (proposed 36 CFR Part 1190; published in the Federal Register, July 26, 2011).
16. **REVERSION** – In the event that the Licensed Premises is needed for a transportation project, Licensee shall remove any and all of its Improvements from the Licensed Premises and surrender all rights and privileges under this License Agreement within 60 days of receiving written notice from the State. In the event that the Licensed Premises is needed for a highway maintenance project, the use of the Licensed Premises will cease temporarily until the maintenance project is completed. In the event that a utility owner needs to maintain an existing utility facility, the Licensee’s use of the Licensed Premises may cease or be impaired until the utility maintenance activity is completed.
17. **ADJACENT PROPERTY** – Licensee states and affirms that the Improvements constructed and maintained on the Licensed Premises are not relevant to any adjacent property’s activities, features, or attributes that qualify the adjacent property for protection under Section 4(f) of the Department of Transportation Act of 1966 (Pub. L. 89—670, 80 Stat. 931) now codified at 23 U.S.C. § 138, 49 U.S.C. § 303, and 23 CFR Part 774 (hereinafter referred to as “Section 4(f)”).

License Agreement
Request No. 6893

Therefore, neither the act of reversion nor termination of this Agreement, nor any transportation related activities occurring on the Licensed Premises (including, but not limited to, maintenance activities, construction activities, etc.), would result in a substantial impairment to the activities, features, or attributes that may qualify Licensee's adjacent or nearby property for protection under Section 4(f).

18. **NO PERMANENT OWNERSHIP** – Licensee does not currently possess, nor through this Agreement acquire, permanent ownership or control over the Licensed Premises.
19. **TERMINATION** – The State may terminate this License at will with 60 days written notice to Licensee.
20. **ASSIGNMENT** – The license shall not be transferred, conveyed or assigned to another party without prior written approval from the State.

TO THE LICENSEE:

City of Crossville, Tennessee
392 N. Main Street
Crossville, Tennessee 38555

TO THE STATE:

State of Tennessee
Department of Transportation
Suite 700, James K. Polk Building
505 Deaderick Street
Nashville, Tennessee 37243-0337

IN WITNESS WHEREOF, the parties hereto have caused this Agreement to be executed the day and year first above written.

LICENSEE:

CITY OF CROSSVILLE, TENNESSEE

James Mayberry, Mayor

DATE: _____

APPROVED AS TO FORM
AND LEGALITY:

Attorney for Licensee

DATE: _____

STATE OF TENNESSEE

Joseph Galbato, III, Interim Commissioner
Tennessee Department of Transportation

DATE: _____

APPROVED AS TO FORM
AND LEGALITY:

John Reinbold, General Counsel
Tennessee Department of Transportation

DATE: _____

CITY OF CROSSVILLE, TENNESSEE CUMBERLAND COUNTY

DOWNTOWN PEDESTRIAN IMPROVEMENT PROJECT

CONSTRUCTION
PROJECT LIMITS:
MAIN STREET (US 127 / SR 28) BETWEEN LANTANA ROAD /
HIGHWAY 70 EAST AND NEECHAM STREET

INDEX OF SHEETS

1.0	TITLE SHEET
2.0-2.1	ESTIMATED ROADWAY AND LIGHTING QUANTITIES
3.0	PROPERTY MAP AND ACQUISITION TABLE
4.0-4.2	TYPICAL SECTIONS AND PAVING SCHEDULE
5.0-5.1	GENERAL NOTES
5.2	SPECIAL NOTES
5.3	ENVIRONMENTAL NOTES
5.4	NOT USED
5.5	RIGHT OF WAY NOTES, UTILITY NOTES AND OWNERS
5.6	LEGEND
5.7	STANDARD ROADWAY DRAWINGS
5.8	STANDARD TRAFFIC OPERATIONS DRAWINGS
6.0-6.5	DETAIL SHEETS
7.0-7.4	PRESENT LAYOUTS / DEMOLITION PLANS
8.0-8.4	PROPOSED LAYOUTS
8.5-8.7	SIDEWALK LAYOUT DETAILS
9.0-9.4	EXISTING GRADING PLANS
10.0-10.9	PROPOSED GRADING PLANS
11.0-11.5	EROSION PREVENTION AND SEDIMENT CONTROL PLANS
12.0-12.5	TRAFFIC CONTROL PLANS
13.0-13.5	SIGNING AND PAVEMENT MARKING PLANS
14.1-14.4	SIGNAL PLANS
15.0	NOT USED
16.0-16.09	LIGHTING PLANS

DATUM ADJUSTMENT FACTOR

COORDINATES ARE NAD/83 (1995), ARE DATUM ADJUSTED BY THE FACTOR OF 1.000000 (NO DATUM ADJUSTMENT), AND TIED TO THE TOWN. ALL ELEVATIONS ARE REFERENCED TO NAVD 1988.

GENERAL NOTES

THIS PROJECT TO BE CONSTRUCTED UNDER THE STANDARD SPECIFICATIONS OF THE TENNESSEE DEPARTMENT OF TRANSPORTATION DATED JANUARY 1, 2021 AND ADDITIONAL SPECIFICATIONS AND SPECIAL PROVISIONS CONTAINED IN THE PLANS AND IN THE PROPOSAL CONTRACT.

SPECIAL NOTES

PROPOSALS MAY BE REJECTED BY THE CITY OF CROSSVILLE IF ANY OF THE UNIT PRICES CONTAINED THEREIN ARE OBVIOUSLY UNBALANCED, EITHER EXCESSIVE OR BELOW THE REASONABLE COST ANALYSIS VALUE.

CITY OF CROSSVILLE ENGINEERING DEPARTMENT **JIM BEGLEY**
PUBLIC WORKS DIRECTOR
DESIGNED BY **CT CONSULTANTS, INC.**
DESIGNER **JAMES G. GOLIAS B. P.E.**

CONSTRUCTION

LOCALLY MANAGED & LET PROJECT
PIN: 126662.00
FEDERAL PROJECT NO.: TAP-28(68)
STATE PROJECT NO.: 18LPLM-F3-015
TDOT REGION 2
PROJECT LENGTH: 1,983 LF

CT CONSULTANTS, INC.

PETERS, TSCHANTZ & ASSOCIATES, INC.

HART FREELAND ROBERTS, INC.

ENGINEER-ARCHITECTS-PLANNERS
NASHVILLE, TENNESSEE (615) 349-4024

CONSULTING ELECTRICAL ENGINEERS
AKRON, OHIO (330) 686-3702

SURVEYOR
BRENTWOOD, TENNESSEE (615) 370-8500

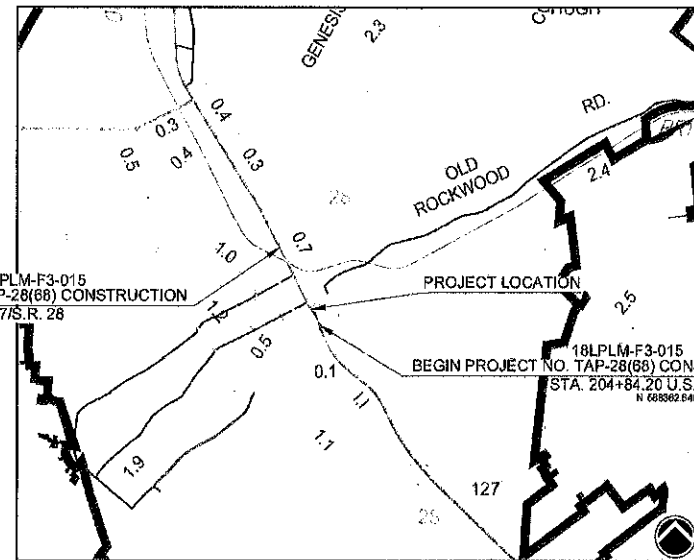

COORDINATES: 35.8459, -85.0249

SCALE: 1" = 2,000'

COUNTY MAP

PROJECT LOCATION

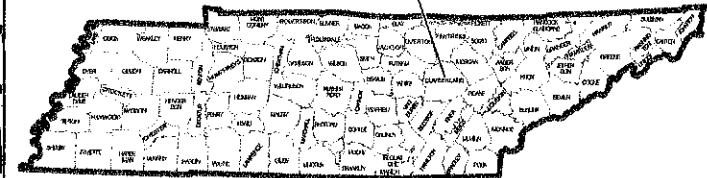

US 127 / SR-28 (MAIN ST.) 2022 ADT:	16,950
US 127 / SR-28 (MAIN ST.) 2042 ADT:	18,650
DESIGN SPEED:	35 MPH
SURVEY DATE:	2010



APPROVED: _____ MAYOR, CITY OF CROSSVILLE, TN _____ DATE